

rollz[®] motion umbrella

Rollz Motion umbrella Assembly and handling manual



 Nederlandse handleiding op
rollz.com/rollz-handleidingen



 Manuel en français sur
www.rollz.com/fr/manuels-rollz



 Deutsche Bedienungsanleitung
auf rollz.com/de/rollz-bedienungsanleitungen

www.rollz.com



Please read this assembly and handling manual before installing the product.

Introduction

Thank you and congratulations with the purchase of the Rollz Motion umbrella, an original product of MPB (from Bielefeld, Germany).

Before installing the rollator umbrella, read the assembly and handling manual and note all the safety instructions. When the assembling of the umbrella has been completed you can start enjoying the best quality and easy handling of this original MPB product.

All MPB rollator umbrellas give optimal protection against rain and sun, as they block the harmful UV radiation almost completely.

The patented Air-Vent-System ensures stability in windy weather.

Because of the space-saving placement on the right side (usually) you can use your rollator with both hands without being restricted.

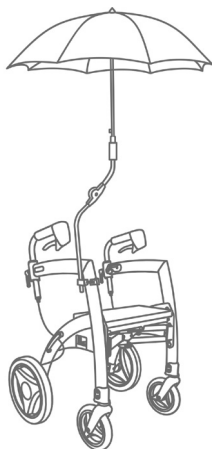

Content of the package

In the package you will find:

- a rollator umbrella with two adjustable joints and a cover (figure 1);
- the pre-assembled mounting clamp for the Rollz Motion (figure 2);
- a screw-thread protection that can be shortened with a scissor;
- an Allen key for easy installation of the Rollz Motion umbrella.

WARNING



Plastic bags can be dangerous!

To avoid suffocation, keep the plastic bag of the packaging away from infants and little children.



Figure 1: Umbrella with two adjustable joints and unlock buttons, including cover.

Assembly on the rollator

The mounting clamp is pre-assembled for mounting on the right side (when you stand behind the rollator) of your Rollz Motion. If you prefer to mount it on the left side, please read the paragraph 'mounting on the left side'.

The clamp consists of two parts. First attach the rollator part on the frame of your Rollz Motion. Then fasten the umbrella to the umbrella part. Find out how to assemble it on the next pages.

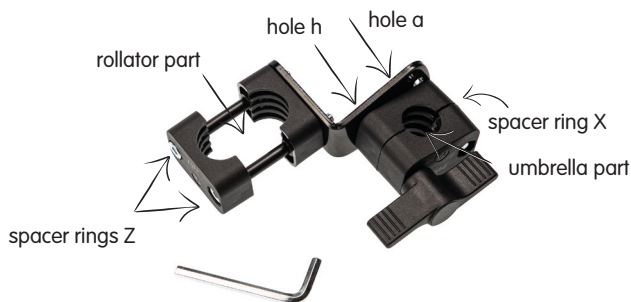

Figure 2: Pre-assembled mounting clamp for the Rollz Motion umbrella and an Allen key.

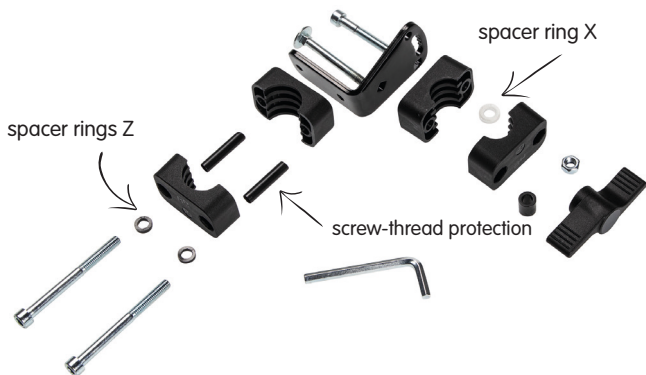

Figure 3: All the necessary parts for fitting the umbrella on the right side of the Rollz Motion.



Figure 4: The mounting clamp should be placed on the frame of your Rollz Motion as high as possible.

Assembling goes as follows:

- Make sure to not lose the small pre-mounted spacer rings Z placed in-between the clamps of the umbrella part. They should always remain on the long screws.
- Shorten the screw-thread protections (figure 2 and 3) with a scissor. Wrap them around the two screws to protect the frame of your rollator.
- Fix the mounting clamp as high as possible on the frame, with help of the Allen key (figure 4). The plastic wing nut must point outwards.
- Tighten the screws firmly.
- You can now place the umbrella pole in the umbrella clamp from above and tighten the plastic wing nut (figure 4).
- The adjusting ring Y (figure 5) can be placed on the umbrella pole for setting the umbrella to the desired height. You can choose from a maximum of three different heights.
- Tighten the screws again after two days.

Figure 5: Attaching the adjusting ring Y.



Assembly on the right side

The mounting clamp is preassembled for fitting on the right side of the frame. The position of the adjustment holes should not be changed.

The umbrella part of the clamp (with the plastic wing nut) is preassembled in the mounting bracket as follows:

- A screw in the square hole **h**;
- An Allen screw in hole **a**.



Figure 6: Rollz Motion umbrella in the mounting clamp.

And that is how the mounting clamp can be assembled for the right side of your Rollz Motion.

Assembly on the left side

Do you prefer to attach the umbrella to the left side? Then use hole **e** in the mounting bracket (figure 7). Please ensure that the small spacer ring X is placed between the two clamps of the umbrella part, around the long Allen screw (as showed on figures 2 and 3).

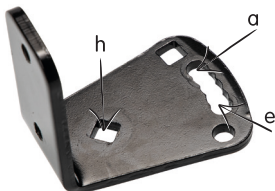

Figure 7: Mounting bracket (part of the clamp).

Handling manual of the rollator umbrella

Thanks to the long adjustable tube, the umbrella can be used by people with heights up to 200 cm. When the umbrella is not used, it can remain attached to the frame. The lock button will allow to fold the umbrella, with the tip pointing downwards (figure 6).



Figure 8: The lock button helps adjusting the tube



Figure 9: Set the umbrella to the desired position.



Figure 10: Protects from sun and rain.

INSTRUCTIONS

We recommend that you practice opening and closing the umbrella before using it for the first time.

- When tightening the ergonomically shaped plastic wing nut you can easily stop the umbrella from twisting and turning.
- Do you want to open the umbrella? Then make sure to first remove its cover.
- By pressing the grey lock button on the adjustment joint (figure 8) you can change the position of the umbrella and place it on the desired one (figure 9).
- After all of the above steps have been completed, open the two Velcro straps on the umbrella.
- Press the opening button of the umbrella.



Attention! The umbrella opens very fast and has a wide umbrella canopy - please keep the safety instructions in mind.

- If you used the umbrella in rain make sure to let it dry before stowing it away. Follow the above instructions in reverse order to close the umbrella when completely dry.



- Attention! Be careful to not catch your fingers between the hinges.

Warnings, tips and safety instructions

WARNINGS



- The wind can get hold of any umbrella. If it is windy outside then you may not want to open the umbrella. Also, if you have the feeling that the unfolded umbrella has a negative effect on driving with the walker, then you should fold it (as showed at figure 6). Only this way accidents and injuries can be prevented.
- The umbrella opens very quickly when pushing the open button. Please keep the umbrella away from your body. Also, pay attention to other people nearby to avoid accidents.

TIPS

- Please note that when the umbrella is open, you will need more space on the left and right sides of the rollator to not get stuck into things.
- Also, pay attention to the overall height of your umbrella so that you do not collide with extended awnings, for example.
- Before entering a building, make sure the umbrella is closed and folded down.
- Be aware that the fabric of the umbrella can be damaged by hedges, fences, cigarettes and bushes.
- When you do not use the umbrella please protect its highquality fabric by closing and folding the umbrella. Secure it with the Velcros and put the cover over it.
- Use the cover only when the umbrella is completely dried, to avoid mold and/or discoloration of the fabric.

- Protect your dried umbrella with the supplied cover. Avoid rubbing the umbrella to the handlebars and brakes of the Rollz Motion.
- Replacement of defective parts may only be done with original MPB spare parts.
- This product can not be used in defective condition.
- This manual is part of the Rollz MPB-umbrella and must be kept for future reference. When passing on the product to third parties, please also hand over the manual. Changes to this version might occur.

SAFETY INSTRUCTIONS

- When using the product, always make sure you have a free field of view. Do not hamper other pedestrians and road users.
- The umbrella must be fitted on the frame in a way that it does not restrict the folding mechanism of the rollator and the function of important parts such as the brakes.
- For safety reasons, please check regularly if the screws are properly tightened.
- Be aware of the risk of getting your fingers stuck in the hinges when folding the umbrella.
- Keep in mind that when having an umbrella attached to your rollator you are ‚taller‘ and ‚wider‘.
- When opening and closing the umbrella there is risk of injuring others walking close to you.

Warranty

This product can only be returned when the proof of purchase is attached. Contact your dealer for the return procedure. The warranty period is 2 years. Mechanical damage and burn holes are not covered.

Contact

Rollz International is always open for comments and suggestions, which can be about the handling of the product, the manual or other aspects of our products or services. You can send your tips or experiences at info@rollz.com.

Bekijk de Nederlandse handleiding op www.rollz.com/rollz-handleidingen
Lesen Sie die Bedienungsanleitung auf www.rollz.com/de/rollz-bedienungsanleitungen/
Consultez le manuel en français sur www.rollz.com/fr/manuels-rollz



Rollz® International bv
Treubweg 51 bg
1112 BA Diemen
The Netherlands

+31 (0) 20 362 20 10
info@rollz.com
www.rollz.com